



2/10 Platypus Close Figtree NSW

2 1 1

This spacious townhouse is perfect for first home buyers or investors. Great floor plan and neat as a pin. The living room is filled with natural light, is large enough for all the furniture and flows through the dining area out to a sun filled courtyard. Open kitchen with ample storage. Internal laundry with plenty of elbowroom. There is even a powder room off a foyer behind the kitchen so guests don't have to go upstairs.

Upstairs are 2 sizable bedrooms with built-ins set off by polished floorboards. A full bathroom with separate shower is more than enough to service the two bedrooms.

The garage has internal access offering extra security.

There are only 3 in the block and it backs onto the reserve. Close to public transport, schools, shops, parks. Away

Price : \$ 537,000

View : <https://www.jacksonresidential.com.au/6046932>



Mark Jackson
02 4226 3000

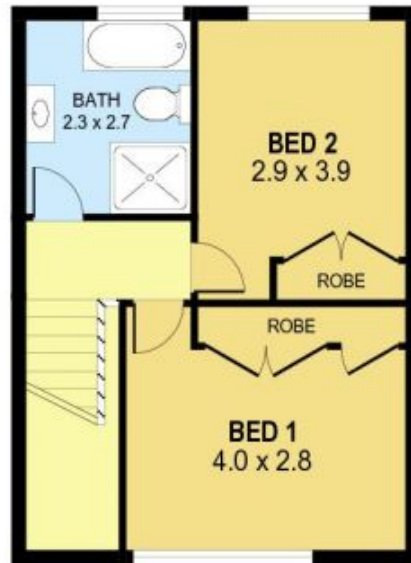

UPPER LEVEL

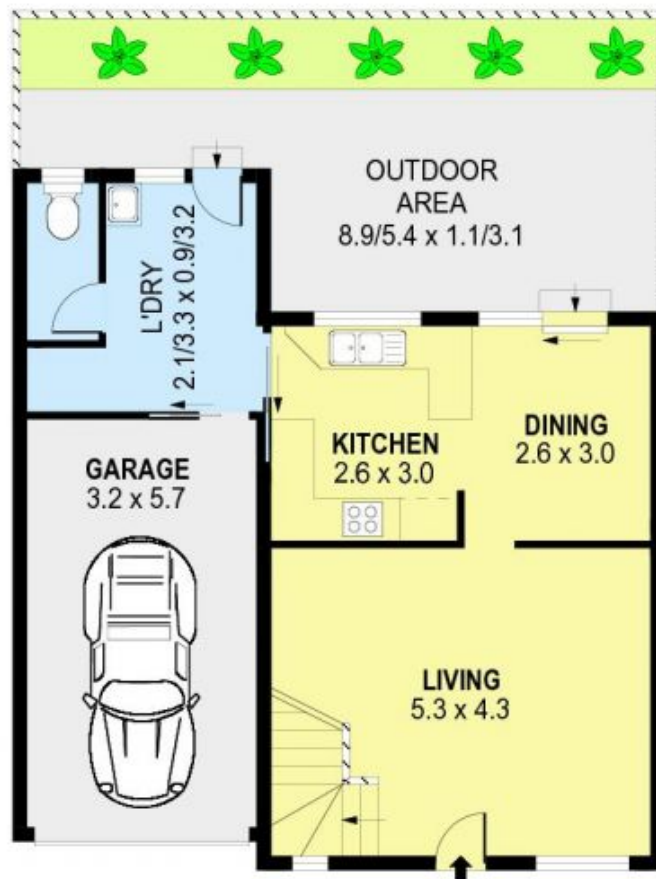

GROUND LEVEL



PLANS SHOWN ONLY INDICATIVE OF LAYOUT. DIMENSIONS ARE APPROXIMATE.
Ref. No: 55188

INT : 89m²
EXT : 21m²
GARAGE : 18m²

UNIT 2, 10 PLATYPUS CLOSE

FIGTREE