



**9/20-26 Addison Street Shellharbour NSW**

**2 2 1**

Presenting an outstanding lifestyle choice, this sunny and fashionable apartment located in "Stella Maritz" reveals modern updates over a highly functional and practical layout. It promotes easy-care living, while it's convenient beach-side address is within a stroll to Shellharbour beach and just footsteps to village shops, cafes and eateries.

The apartment offers large and combined living/dining area opening freely onto an easterly facing balcony. This area also adjoins the spacious and modern polyurethane kitchen complete with stone benches, dishwasher and stainless steel appliances.

There are two large bedrooms conveniently appointed with built-in wardrobes and the benefits of a private ensuite accessible by the master bedroom suite.

**Price** : \$ 470,000

**View** : <https://www.jacksonresidential.com.au/6047036>



**Mark Jackson**  
**02 4226 3000**



**MarkDeleted MasonDeleted**

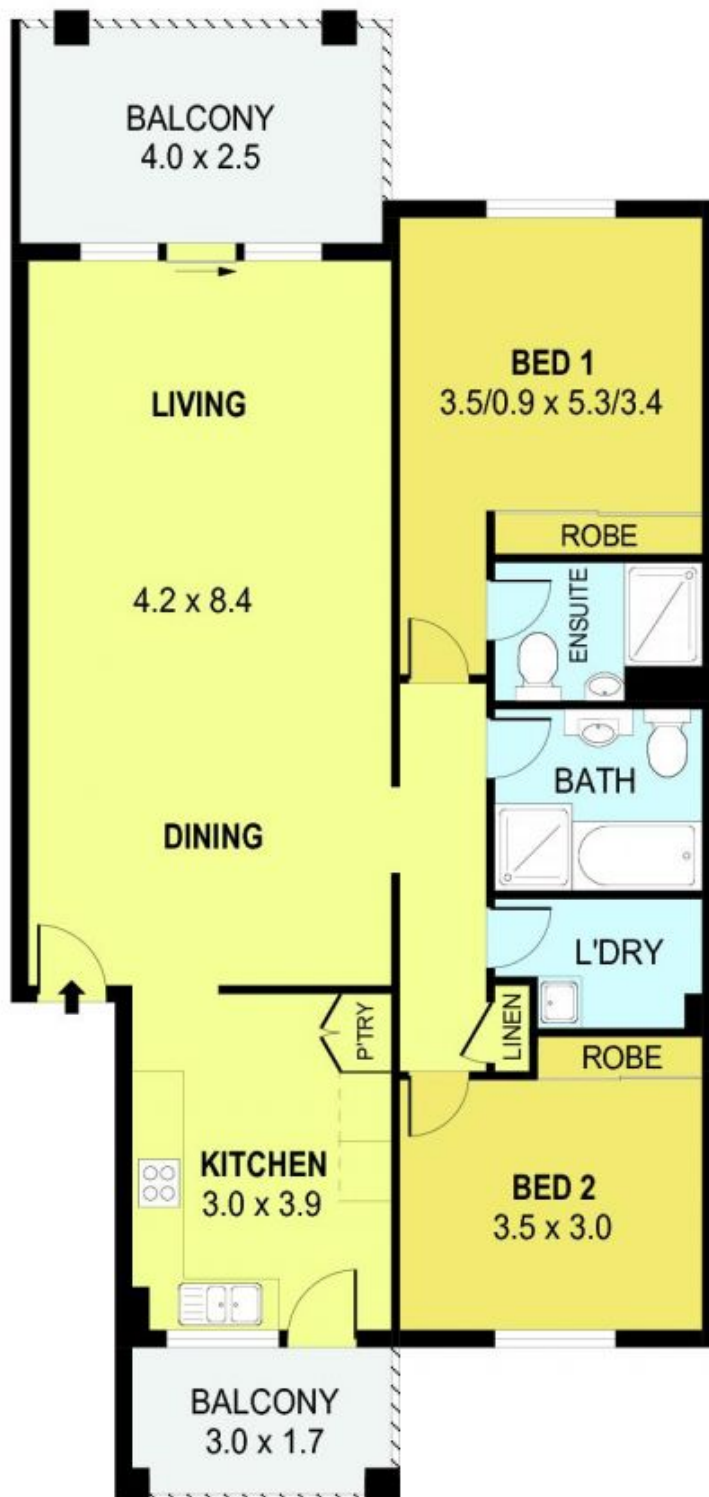

PLANS SHOWN ONLY INDICATIVE OF LAYOUT. DIMENSIONS ARE APPROXIMATE.  
Ref. No: 35032

INT : 94m<sup>2</sup>  
EXT : 15m<sup>2</sup>  
GARAGE : 20m<sup>2</sup>

UNIT 9, 20-26 ADDISON STREET

SHELLHARBOUR