



## 2/12 Northview Terrace Figtree NSW

4 2 2

This oversized apartment represents value for first home buyers or investors. Plenty of natural light, flowing floorplan with living areas opening to the covered north facing 17m long deck. Fully tiled for easy maintenance making it a wonderful family home for busy couples. In a cul-de-sac a few minutes drive to Figtree Mall.

### Highlights:

- \* Master bedroom with ensuite and walk-in robe
- \* 3 bedrooms with built-ins
- \* Vast open plan kitchen/dining/family with ample cabinetry
- \* Separate living room
- \* Full main bathroom
- \* Reverse cycle air conditioning
- \* Ceiling fans in all rooms
- \* Large double garage (with laundry)

**Price** : \$ 530,000

**View** : <https://www.jacksonresidential.com.au/6047230>



**Mark Jackson**  
02 4226 3000



**MarkDeleted MasonDeleted**

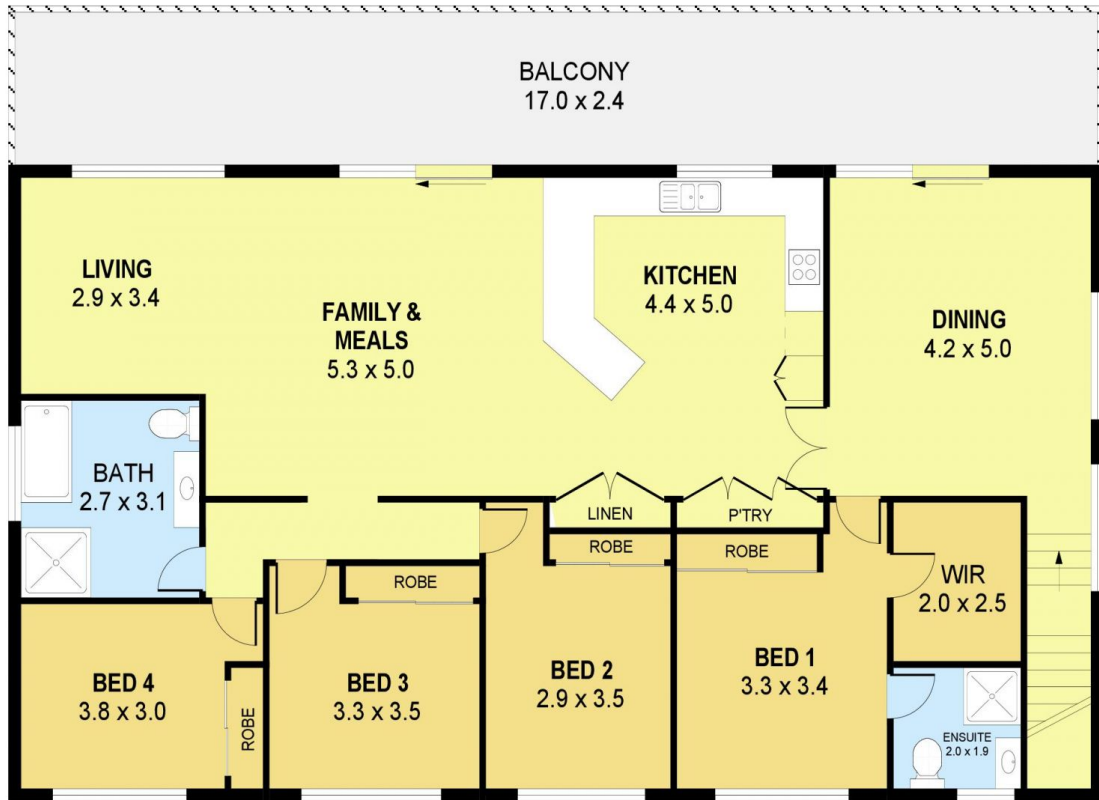

UPPER LEVEL

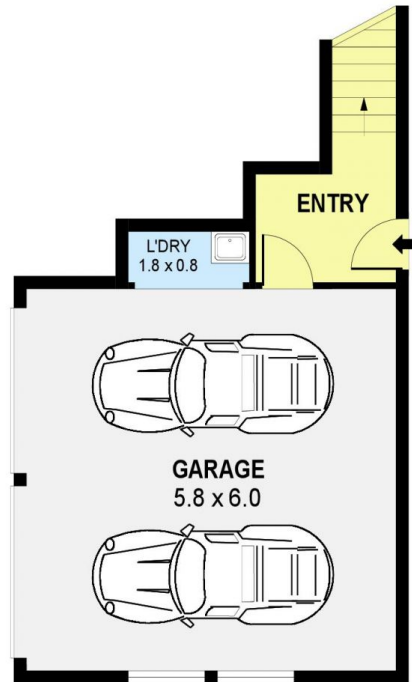

GROUND LEVEL



PLANS SHOWN ONLY INDICATIVE OF LAYOUT. DIMENSIONS ARE APPROXIMATE.  
Ref. No: 80304

INT : 169m<sup>2</sup>  
EXT : 41m<sup>2</sup>  
GARAGE : 35m<sup>2</sup>

UNIT 2, 12 NORTHVIEW TERRACE

FIGTREE