

28 Graham Avenue Gwynneville NSW

4 🏠 1 🛏

This property has a charming renovated one bedroom cottage at the front. At the rear it has the shell of 3 bedrooms ready to be completed. The rooms have the option to be converted in bedsits with a bathroom and kitchenette. A spacious new laundry has been completed. With only a short walk to TAFE and UOW the rooms are perfect for student accommodation.

Land Size : 357 sqm

View : <https://www.jacksonresidential.com.au/6314283>

Highlights:

- * Pretty, tastefully renovated one bedroom cottage, tenanted
- * Large new laundry
- * 3 incomplete bedrooms.
- * Some building materials for the fit out
- * Easy access to TAFE, UOW, freeway



Mark Jackson
02 4226 3000

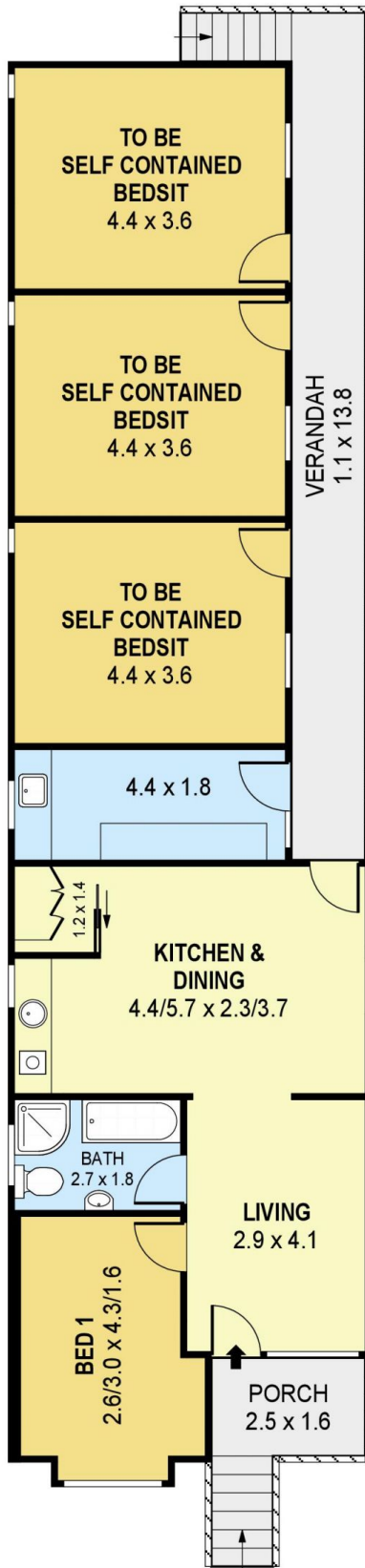

SCALE (METRES)

PLANS SHOWN ONLY INDICATIVE OF LAYOUT. DIMENSIONS ARE APPROXIMATE.
Ref. No: 86864

INTERNAL : 51m²
 EXTERNAL : 21m²
 SELF CONTAINED BEDROOMS / L'DRY : 57m²

28 GRAHAM AVENUE

GWYNNEVILLE