



5 Crawford Avenue Gwynneville NSW

3  1 

Updated 3 bedroom cottage with so much appeal. Modern kitchen with timber benchtops. Open plan living and dining area leading to a spacious covered deck. The backyard is perfect for the kids to play. Robinson Park is across the street and it's only a short walk to bus and station. In a sought after pocket in Gwynneville.

Price : \$ 871,000
Land Size : 588.1 sqm
View : <https://www.jacksonresidential.com.au/6314504>

Highlights:
3 bedrooms
Modern kitchen with dishwasher
Timber deck
Ornate cornices
Picture rails
Fully fenced back yard
Street appeal
Top location



Mark Jackson
02 4226 3000

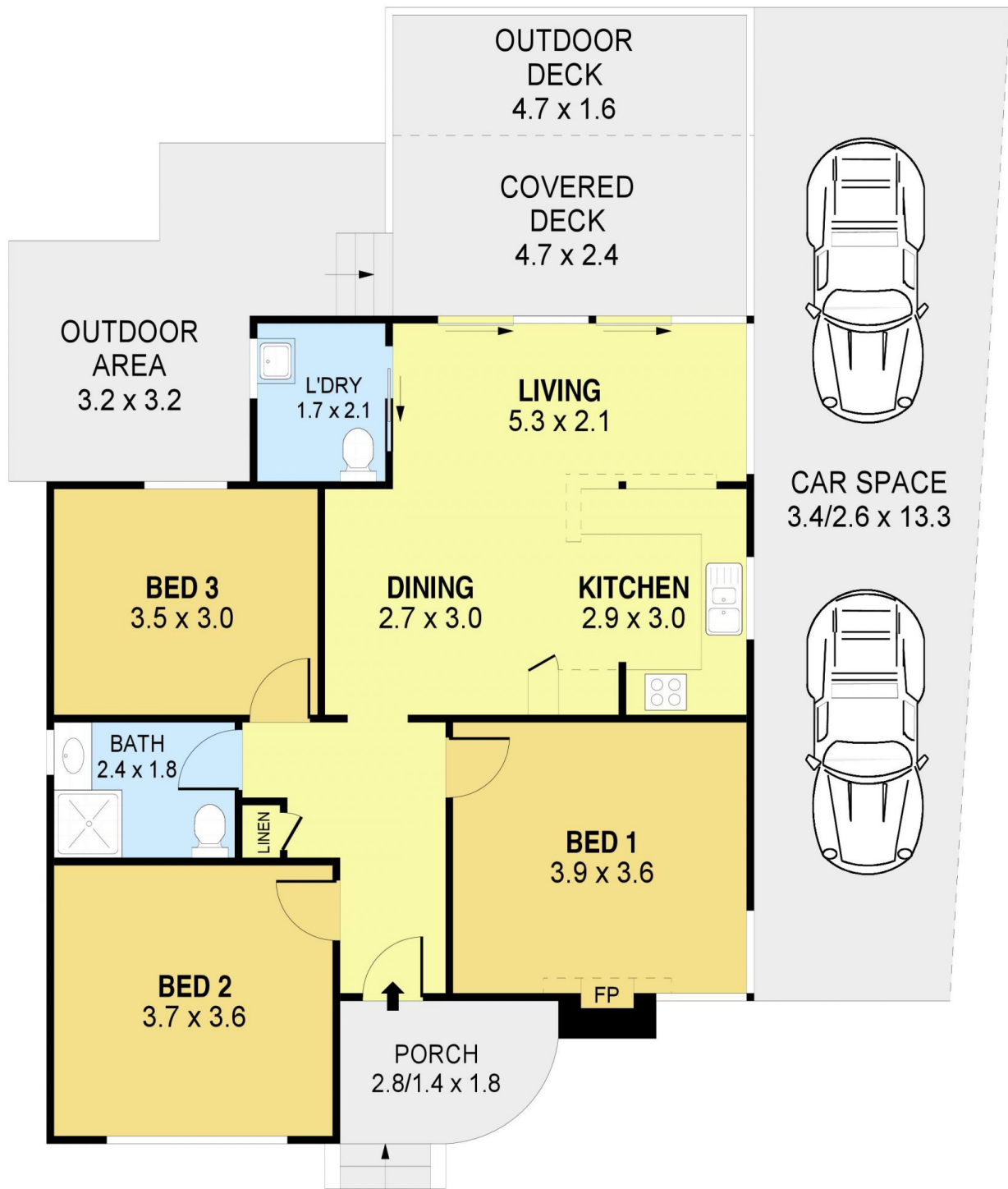

SCALE (METRES)

PLANS SHOWN ONLY INDICATIVE OF LAYOUT. DIMENSIONS ARE APPROXIMATE.
Ref. No: 86937

INT : 83m²
EXT : 40m²
CAR SPACE : 40m²

5 CRAWFORD AVENUE

GWYNNEVILLE