

65 Atchison Street Wollongong NSW

3 1 1

This charismatic three bedroom home is reminiscent of a bygone era. Period features such as cedar tongue and groove walls and ceilings and huon pine floors are just a part of the charm. Entertainers back deck overlooking a back yard big enough for the family cricket match. Adding to the allure is the location in a quiet enclave in town. No more parking issues for restaurants, concerts and the footy. This elegant lady is calling for a new family to fall in love with her.

Highlights:

- Street appeal
- Spacious bedrooms
- Separate living and dining
- Galley kitchen
- Lovely back deck and big back yard
- High ceilings
- Tongue and groove cedar walls and ceilings

Land Size : 613 sqm

View : <https://www.jacksonresidential.com.au/6370845>



Mark Jackson
02 4226 3000



Robyn Elliott
4226 3000

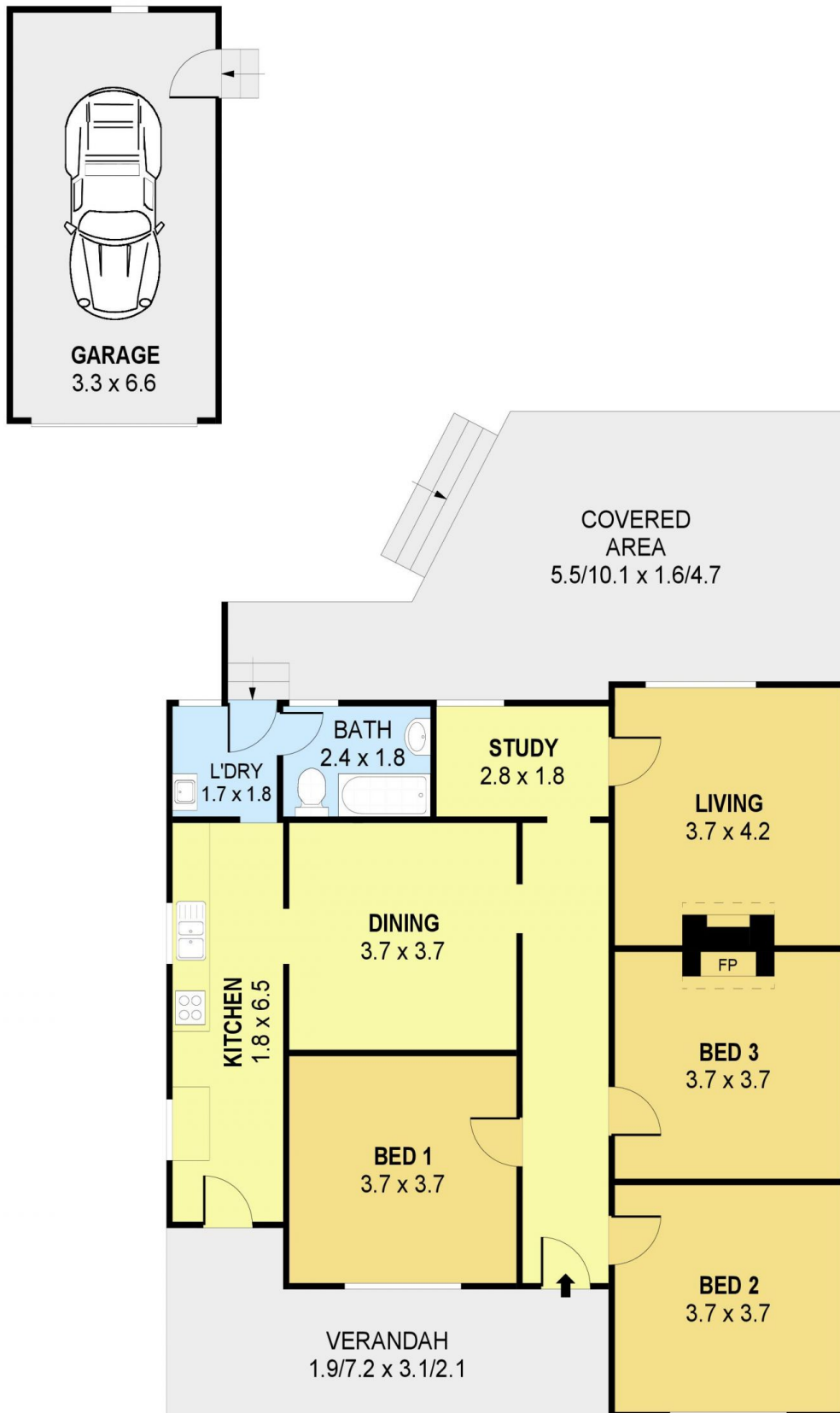

0 1 2 3 4 5
SCALE (METRES)

PLANS SHOWN ONLY INDICATIVE OF LAYOUT. DIMENSIONS ARE APPROXIMATE.
Ref. No: 87963

INT : 109m²
EXT : 52m²
GARAGE : 22m²

65 ATCHISON STREET

WOLLONGONG