



## 5 Greenacre Road Wollongong NSW

4  2  1 

Character cottage with all the charm of yesteryear - stained glass windows, ornate ceiling cornices, picture rails, 2 bay windows, open fireplace. Offering here 3 bedrooms plus an attached granny flat with a living room, bedroom, kitchen and shower.

In a fabulous position near Wollongong Hospital, Beaton Park, Gwynneville Village and minutes to the CBD. Currently tenanted.

### Highlights:

- 2 bay windows
- Stained glass windows
- Ornate cornices
- Timber floors
- Open fireplace
- 4 bedrooms
- 2 living areas

**Price** : \$ 1,020,000

**Land Size** : 569 sqm

**View** : <https://www.jacksonresidential.com.au/6428473>



**Mark Jackson**  
02 4226 3000



**Robyn Elliott**  
4226 3000

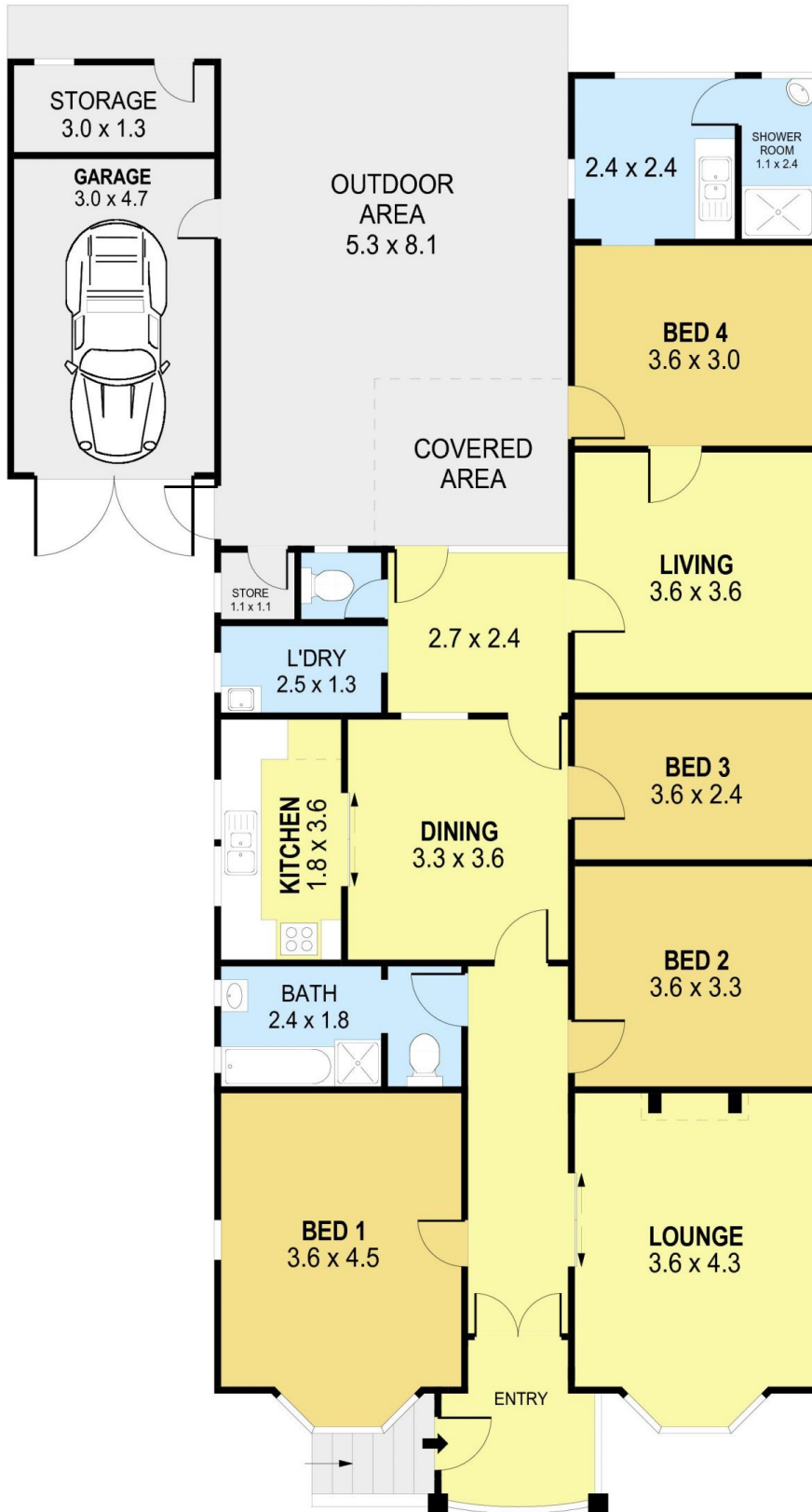

0 1 2 3 4 5 **SCALE (METRES)**

PLANS SHOWN ONLY INDICATIVE OF LAYOUT. DIMENSIONS ARE APPROXIMATE.  
Ref. No: 73098

INT : 141m<sup>2</sup>  
EXT : 45m<sup>2</sup>  
GARAGE : 14m<sup>2</sup>  
STORAGE/STORE : 5m<sup>2</sup>

5 GREENACRE ROAD

WOLLONGONG