



## 8/4 Catherine Street Gwynneville NSW

2 1 1

Discover effortless, low-maintenance living in one of Gwynneville's most coveted neighbourhoods.

This secure home offers generous proportions and is positioned at the centre of a boutique block ensuring your privacy and quiet enjoyment.

As you step inside, you'll be welcomed by the spacious living and dining area, drenched in natural light. The separate kitchen and meal area, complete with ample storage and a sun-soaked view, make it the ideal place for meal prep and social gatherings. The spacious bedrooms feature convenient large built-in robes, thoughtfully positioned just across the entrance hall from the bathroom, which includes a separate shower and toilet.

Convenience is a way of life here, with public transport,

**Price** : \$ 742,500  
**Building Size** : 141 sqm  
**View** : <https://www.jacksonresidential.com.au/822519>



**Mark Jackson**  
02 4226 3000

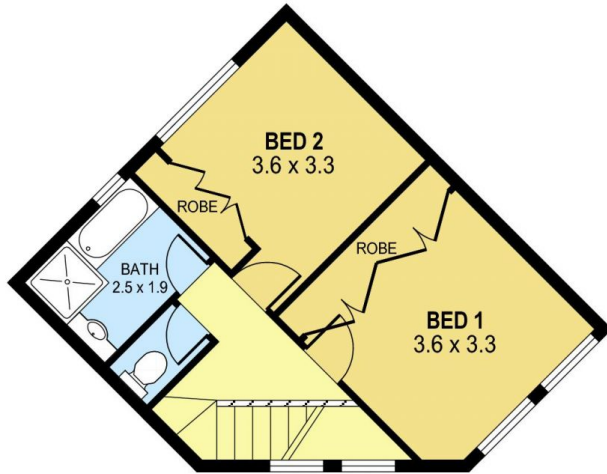

UPPER LEVEL

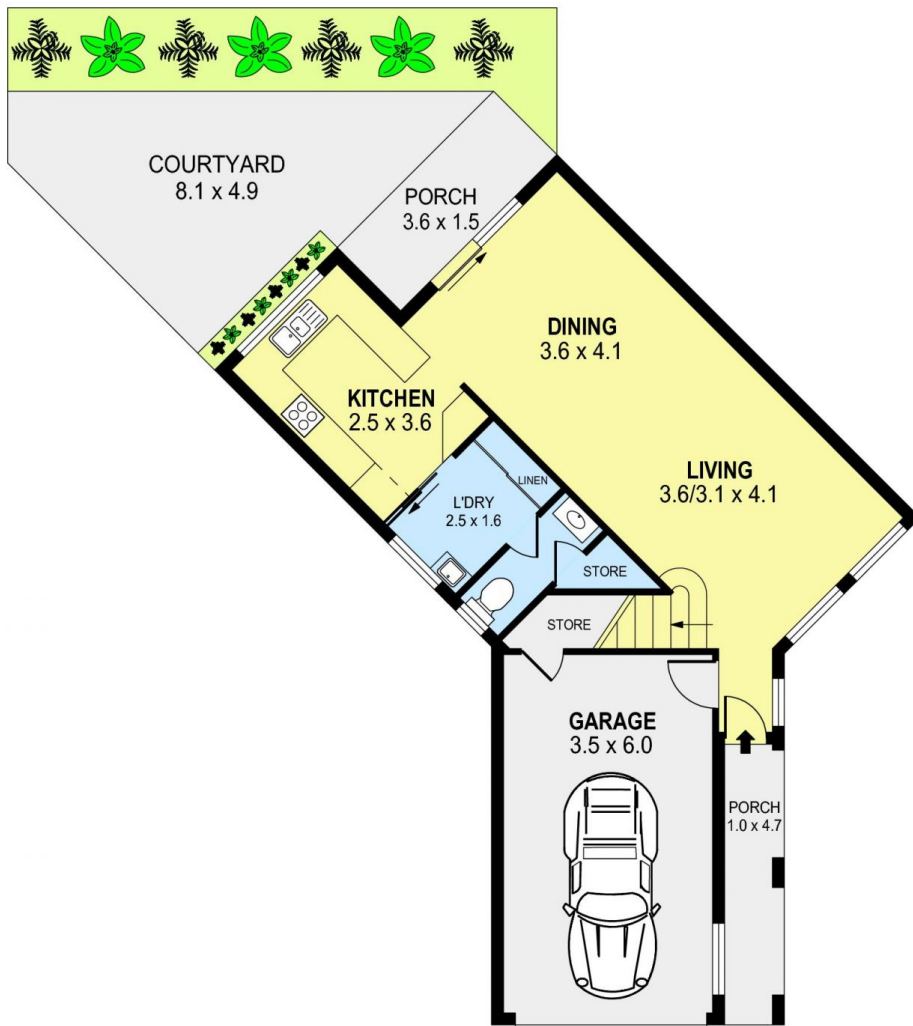

GROUND LEVEL



SCALE (METRES)

PLANS SHOWN ONLY INDICATIVE OF LAYOUT. DIMENSIONS ARE APPROXIMATE.  
Ref. No: 106825

INT	: 90m <sup>2</sup>
EXT	: 30m <sup>2</sup>
GARAGE	: 22m <sup>2</sup>

8/4 CATHERINE STREET

GWYNNEVILLE